



TSX - TLX Pedestrian pallet truck with platform



The OM PIMESPO Pedestrian Pallet Truck with flip down platform provides the best combination of productivity, safety and ergonomics with high performance and low-cost operation. These features render this truck indispensable for intensive materials handling operations.

Chassi

The highest spec model in the TSX series has the 3-point support layout as the basic TLX model but includes **INTELLIDRIVE**[®], a patented electro-hydraulic system that enhances the tractive features of the truck. The system adjusts the rear castor wheels (by means of two electronically driven hydraulic cylinders) to optimize the stability of the truck in any situation.



Load capacity: TLX 2000 kg; TSX 2000 kg and 3000 kg

The motor compartment cover is made of polyethylene (PET), a flexible but strong material. The battery cover is also made of the same material and has ample storage space for objects and documents on top.

The standard TLX model has a compact battery compartment (up to 250 Ah), but can be ordered with a large battery compartment (up to 375 Ah) upon request. All the batteries comply with DIN 43535 B standards.

Driver's platform

The platform has a soft rubber mat and a non slip surface that provides maximum operator comfort and safety. The platform is only 170 mm from the ground and when the driver is on board, lowers even further to facilitate easy demounting of the machine. The side guards (optional on the TLX) are padded with polyurethane foam and are at an ideal height for the safe and effective protection of the operator on the platform. The special design of these guards and their simple but secure opening/closing system allow the truck to be easily reconfigured.

The one piece tiller is manufactured from very light but sturdy plastic; the ergonomic handle and optimized layout of the controls create optimal driving conditions. The light finger tip pushbuttons can be operated easily. The tiller provides electric power-assisted steering to reduce operator fatigue and offers maximum comfort stationary and at top speed.

Traction unit

The separately excited traction motors have a rated power of 1.2 kW (TLX) and 2.5 kW (TSX). This feature with the dedicated software offer the benefits of both separate excitation and series excitation:

- Speed control when laden, unladen, and on gradients.
- Energy recovery system with reduced energy consumption.

Braking

The truck has two separate braking systems:

- Service brake Æ Inversion braking on the traction motor (regenerative braking) performed by the electronic control when the butterfly direction control is released
- Handbrake Æ Electromagnetic brake.

Electronic system

The electronic system with MOSFET technology controls both traction and lift motors. The CANBUS serial transmission of electronic signals, reduces the wiring, and the use of automotive connectors all contribute to an excellent record of reliability.

The Temperature Control System in the TLX model controls the temperature of the traction electronics by means of a forced air ventilation system, while the tiller electronic card made with multilayer technology is equipped with a system that maintains the temperature of the logic unit within a predetermined range. This feature has two very important benefits in that it:

- Reduces condensation on the tiller logic unit.
- Increases the average life of the electronic components.

By using proximity sensors instead of mechanical microswitches and reducing the number of remote control switches, the truck has a technical configuration that greatly reduces maintenance costs.

The steering motor is controlled by a dedicated MOSFET electronic card.

Optional equipment

- Compact version (TSX 20 only).
- Cold store version (-30 °C).
- Fork spreads of 520 mm and 650 mm.
- Fork lengths up to 2400 mm.
- Rubber drive wheel.
- Single load roller.
- On-Board Charger.
- Fixed platform.
- Platform with backrest.
- Fixed battery stand.
- Mobile battery stand.

Information and data reported here are not intended as binding in any way and refer to standard truck specification.

TSX - TLX

Technical data

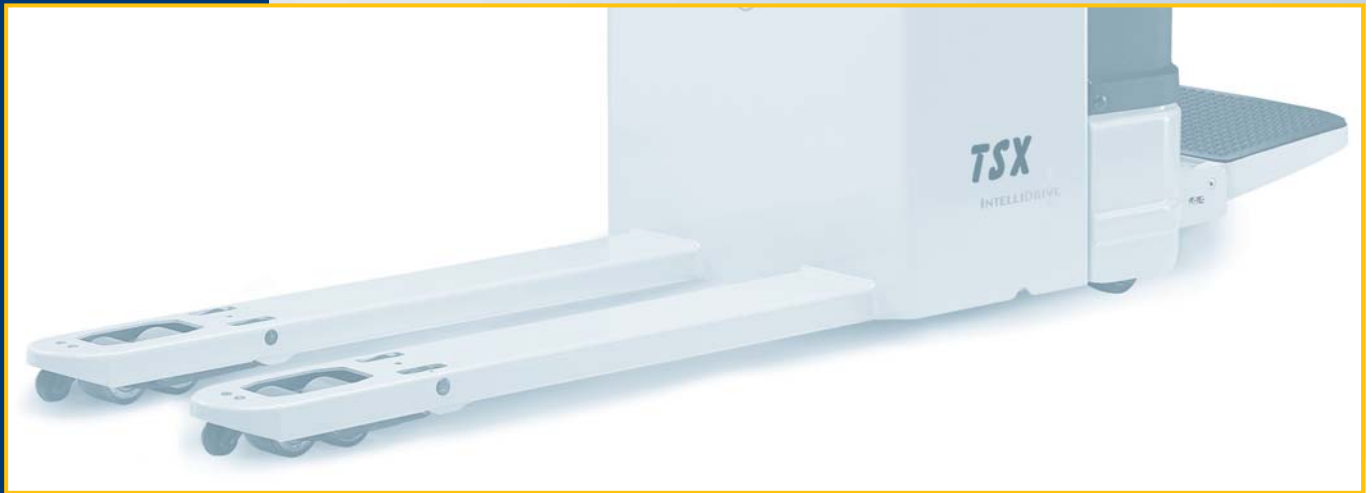

designed to work



TSX - TLX Technical data

VDI 2198

| | | OM PIMESPO | | |
|-----------------|-----------------|--|---|---|
| Characteristics | 1.1 | Manufacturer | OM PIMESPO | |
| | 1.2 | Model designation | TSX 20 | TSX 30 |
| | 1.3 | Power: (electric,diesel,petrol) | Electric | Electric |
| | 1.4 | Operator type: hand, pedestrian, standing, seated, order-picker. | Pedestrian / Stand on platform | |
| Weight | 1.5 | Load capacity | 2 | 3 |
| | 1.6 | Load centre distance | 600 ⁽¹⁾ | 600 ⁽¹⁾ |
| | 1.8 | Load distance | 872 | 872 |
| Wheels, Tyres | 1.9 | Wheelbase | 1376 - (1304) ⁽²⁾ | 1376 |
| | 2.1 | Truck Weight (without battery) | 478 ⁽¹⁾ - (503) ⁽¹⁾⁽²⁾ | 478 ⁽¹⁾ |
| | 2.2 | Axle loading with load load side / driver side | 1787 / 996 - (1750 / 974) ⁽²⁾ | 2590 / 1194 |
| Dimensions | 2.3 | Axle loading without load load side / driver side | 182 / 601 - (167 / 556) ⁽²⁾ | 182 / 601 |
| | 3.1 | Tyres: solid rubber, Polyurethane. | Polyurethane | Polyurethane |
| | 3.2 | Tyre size load side | 85 X 70 | 85 X 70 |
| | 3.3 | Tyre size driver side Drive wheel / Swivel castor wheel | 250 / 95 | 250 / 95 |
| | 3.5 | Wheels number load side / driver side (x=drive wheel) | 4 / 1x-2 | 4 / 1x-2 |
| | 3.6 | Tread load side | 398 - [(358) ⁽⁸⁾ - (488) ⁽⁹⁾] | 398 - [(358) ⁽⁸⁾ - (488) ⁽⁹⁾] |
| | 3.7 | Tread drive side | / | / |
| Performance | 4.4 | Lift height | 135 | 135 |
| | 4.9 | Height of tiller arm in working position (min / max) | 1145 / 1342 | 1145 / 1342 |
| | 4.15 | Lowered height | 85 | 85 |
| | 4.19 | Overall length (Platform closed / open) | 1926 / 2253 - [1854 / 2180] ⁽²⁾ | 1926 / 2253 |
| | 4.20 | Length to front face of forks (Platform closed / open) | 776 / 1102 - [704 / 1030] ⁽²⁾ | 776 / 1102 |
| | 4.21 | Overall width | 710 | 710 |
| | 4.22 | Fork dimensions | 50 / 162 / 1150 ⁽⁴⁾ | 50 / 162 / 1150 ⁽⁴⁾ |
| | 4.25 | Outside fork width dimension | 560 [520 - 650] | 560 [520 - 650] |
| | 4.32 | Ground clearance centre of wheelbase | 168 | 168 |
| | 4.33 | Aisle width pallets 1000 x 1200 crossways (Platform closed / open) | A _{st3} (mm) (1827 / 2134) ⁽⁵⁾⁽⁶⁾ - [1755 / 2062] ⁽²⁾⁽⁵⁾⁽⁶⁾ (2313 / 2620) ⁽⁵⁾⁽⁷⁾ - [2241 / 2548] ⁽²⁾⁽⁵⁾⁽⁷⁾ | (1827 / 2134) ⁽⁵⁾⁽⁶⁾ (2313 / 2620) ⁽⁵⁾⁽⁷⁾ |
| | 4.34 | Aisle width pallets 800 x 1200 lengthwise (Platform closed / open) | A _{st3} (mm) (2197 / 2504) ⁽⁶⁾ - [2125 / 2432] ⁽²⁾⁽⁶⁾ (2387 / 2694) ⁽⁷⁾ - [2315 / 2622] ⁽²⁾⁽⁷⁾ | (2197 / 2504) ⁽⁶⁾ (2387 / 2694) ⁽⁷⁾ |
| | 4.35 | Turning radius (Platform closed / open) | W _a (mm) 1669 / 1976 - [1597 / 1904] ⁽²⁾ | 1669 / 1976 |
| | Electric Motors | 5.1 | Travel speed (with load / without load) | 8,5 / 10,5 |
| 5.2 | | Lift speed (with load / without load) | 0,032 / 0,041 | 0,030 / 0,045 |
| 5.3 | | Lowering speed (with load / without load) | 0,05 / 0,037 | 0,045 |
| 5.7 | | Gradeability (with load / without load) ⁽¹⁾ | *, * / *, * | *, * / *, * |
| Other | 5.8 | Max. Gradeability (with load / without load) ⁽¹⁾ | 10 / 18 | 10 / 18 |
| | 5.10 | Service brake | Electric | Electric |
| Other | 6.1 | Drive motor, S2 60 minute rating | 2,5 | 2,5 |
| | 6.2 | Lifting motor, S3 10% rating | 1,2 | 2,2 |
| | 6.3 | Battery DIN 43531/35/36; A, B, C, no | DIN 43535 B | DIN 43535 B |
| | 6.4 | Battery voltage / capacity at 5 hour rate | 24 / (330 - 375) ⁽³⁾ - [210 - 250] ⁽²⁾ | 24 / (330 - 375) ⁽³⁾ |
| | 6.5 | Battery weight(± 5%) | 305 ⁽⁸⁾ - [220] ⁽²⁾ | 305 |
| Other | 8.1 | Drive control | Electronic | Electronic |
| | 8.4 | Sound level at the driver's ear according to DIN 12053 | < 70 | < 70 |

(1) Value referred to fork dimension l = 1150 x 560 mm

(2) With battery compartment for DIN 24 V / 210 - 250 Ah

(3) With battery compartment for DIN 24 V / 330 - 375 Ah

(4) For different fork length available as option see chart page 1

(5) with forks dimensions l = 980 mm

(6) Value according to the normative for pedestrian pallet truck

(7) Value according to the normative for rider truck or high lift pallet truck

(8) With outside forks dimension b5 = 520mm

(9) With outside forks dimension b5 = 650mm

(10) With opened platform

Information and data reported here are not intended as binding in any way and refer to standard truck specification

For alternative masts see mast-table

For alternative wheels see wheels-table

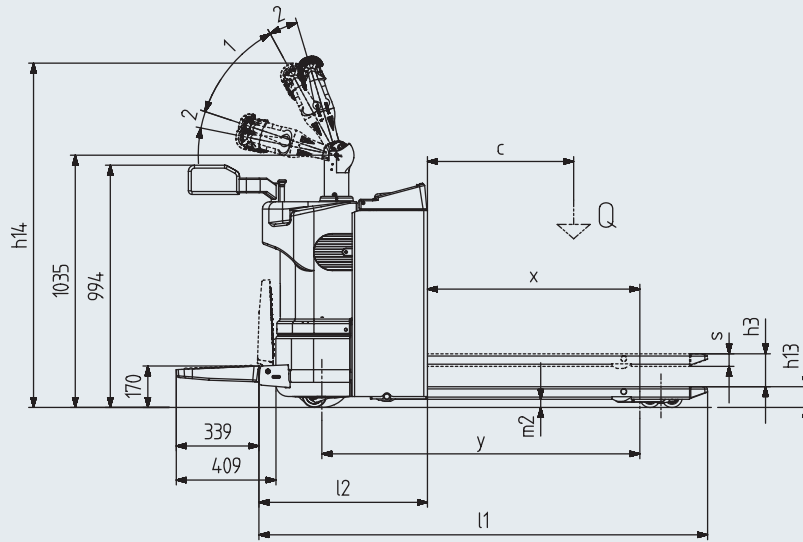

1=Travel
2=Braking

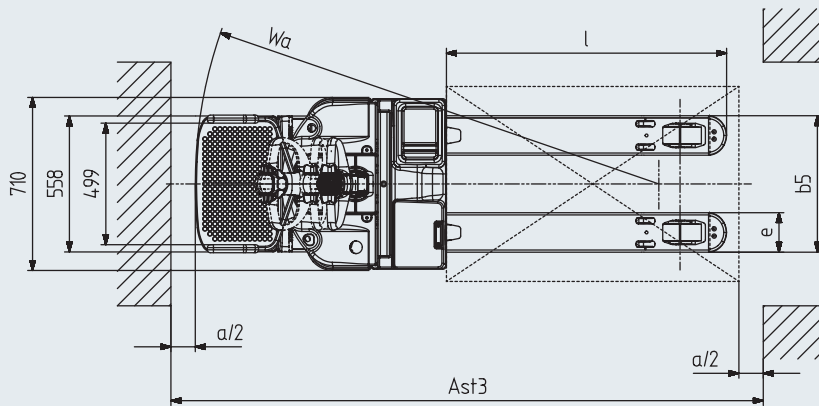

| | | Fork dimensions | | | Battery compartment DIN 24V 210 - 250 Ah | | | | Battery compartment DIN 24V 315 - 375 Ah | | | | | |
|-----------|--------------------|-----------------|--------|------|--|-----------------|------------------|----------------|--|------|-----------------|------------------|----------------|------------------|
| | | l | c | x | y | closed platform | | open platform | | y | closed platform | | open platform | |
| | | | | | | l ₁ | W _a * | l ₁ | W _a * | | l ₁ | W _a * | l ₁ | W _a * |
| | | | | | | [mm] | [mm] | [mm] | [mm] | | [mm] | [mm] | [mm] | [mm] |
| TSX 20-30 | Standard wheelbase | 800 | 400 | 522 | 954 | 1504 | 1247 | 1830 | 1554 | 1026 | 1576 | 1319 | 1903 | 1626 |
| | | 980 | 500 | 702 | 1134 | 1684 | 1427 | 2010 | 1734 | 1206 | 1756 | 1499 | 2083 | 1806 |
| | | 1150 | 600 | 872 | 1304 | 1854 | 1597 | 2180 | 1904 | 1376 | 1926 | 1669 | 2253 | 1976 |
| | | 1450 | 715 | 1172 | 1604 | 2154 | 1897 | 2480 | 2204 | 1676 | 2226 | 1969 | 2553 | 2276 |
| | | 1600 | 800 | 1322 | 1754 | 2304 | 2047 | 2630 | 2354 | 1826 | 2376 | 2119 | 2703 | 2426 |
| | | 1980 | 1000 | 1702 | 2134 | 2684 | 2427 | 3010 | 2734 | 2206 | 2756 | 2499 | 3083 | 2806 |
| | | 2160 | 1072,5 | 1882 | 2314 | 2864 | 2607 | 3190 | 2914 | 2386 | 2936 | 2679 | 3263 | 2986 |
| | | 2400 | 1200 | 2122 | 2554 | 3104 | 2847 | 3430 | 3154 | 2626 | 3176 | 2919 | 3503 | 3226 |
| | Short wheelbase | 1980 pc | 1000 | 1354 | 1790 | 2684 | 2083 | 3010 | 2390 | 1862 | 2756 | 2155 | 3083 | 2462 |
| | | 2160 pc | 1072,5 | 1534 | 1970 | 2864 | 2263 | 3190 | 2570 | 2042 | 2936 | 2335 | 3263 | 2642 |
| 2400 pc | | 1200 | 1774 | 2210 | 3104 | 2503 | 3430 | 2810 | 2282 | 3176 | 2575 | 3503 | 2882 | |
| TLX 20 | | 800 | 400 | 522 | 954 | 1504 | 1247 | 1830 | 1554 | | | | | |
| | | 980 | 500 | 702 | 1134 | 1684 | 1427 | 2010 | 1734 | | | | | |
| | | 1150 | 600 | 872 | 1304 | 1854 | 1597 | 2180 | 1904 | | | | | |
| | | 1450 | 715 | 1172 | 1604 | 2154 | 1897 | 2480 | 2204 | | | | | |
| | | 1600 | 800 | 1322 | 1754 | 2304 | 2047 | 2630 | 2354 | | | | | |

* Value referred with lifted forks

